

## TC Figure 9 Wood to Concrete Separation

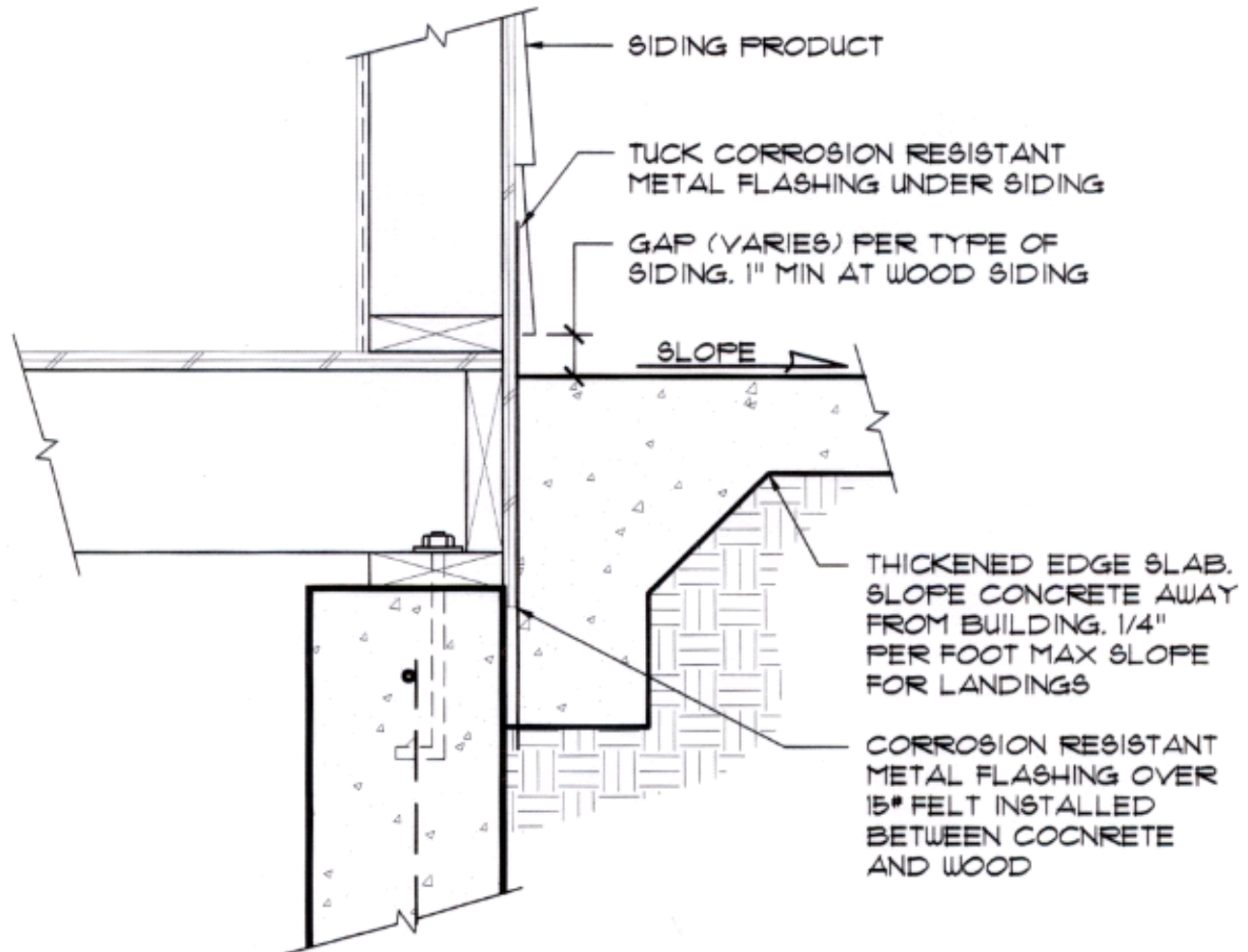

Concrete cannot be poured directly against non-pressure treated wood nor can concrete be poured against manufactured siding.

Concrete can be poured against non-pressure treated wood when flashing and felt paper have been applied over the wood. With wood siding a 1" vertical clearance has to be maintained between the siding and the concrete and with manufactured siding the minimum vertical distance has to be maintained as stated in the manufacturer's installation guide.

## WOOD TO CONCRETE SEPARATION